

PLANTA BAIXA - SALÃO PRINCIPAL

SALÃO PRINCIPAL - 600 lugares
 Palco, aparadores de apoio e mesas de expositores

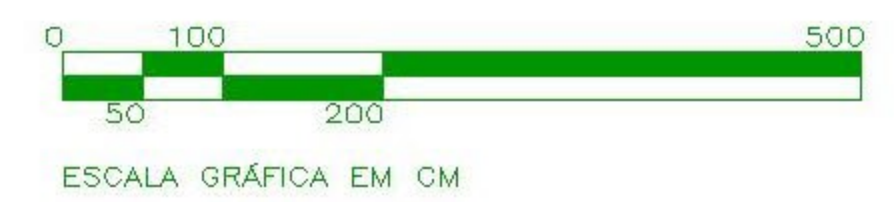

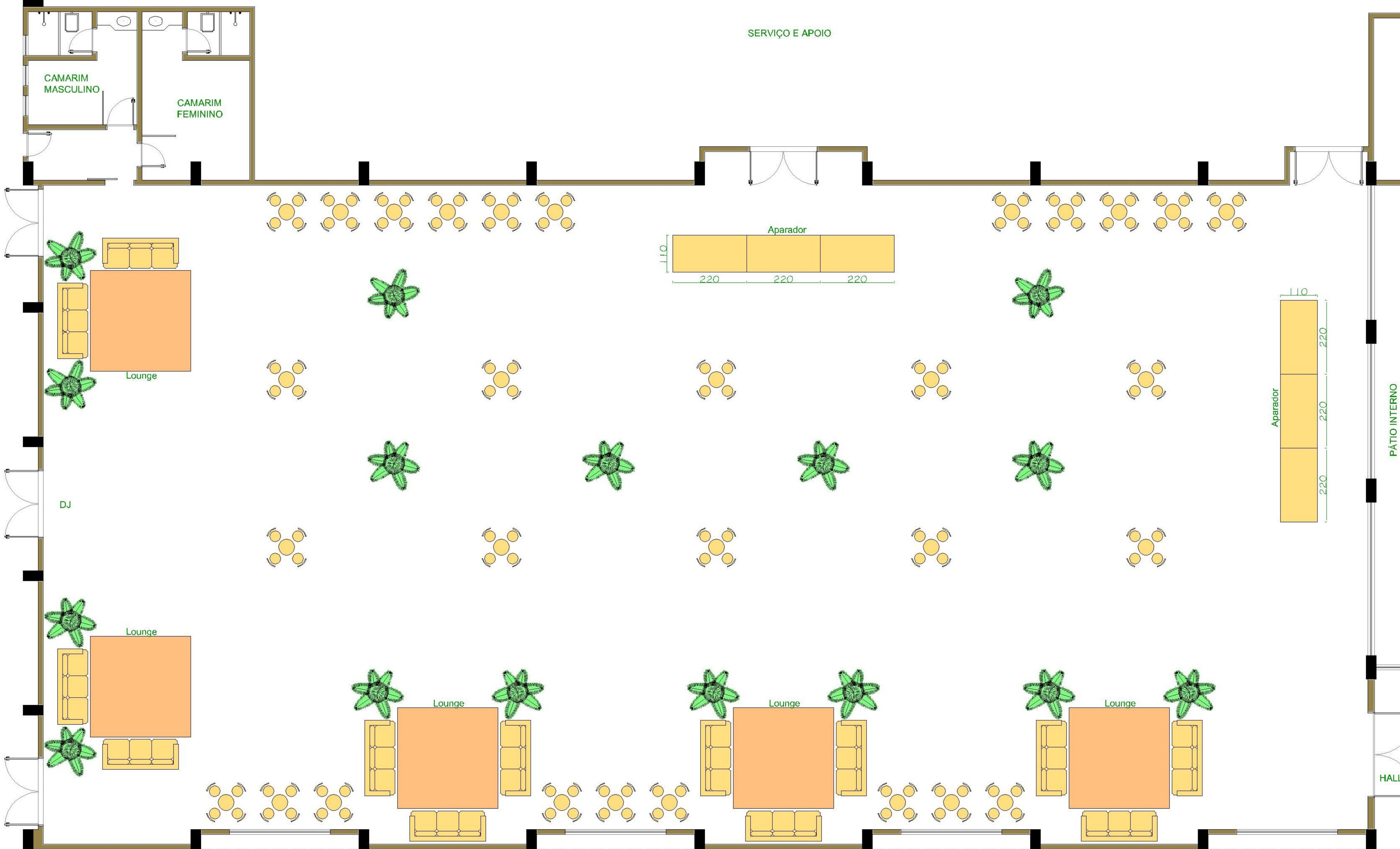

PLANTA BAIXA - SALÃO PRINCIPAL

SALÃO PRINCIPAL - 800 pessoas
Dj, Lounges e bistros

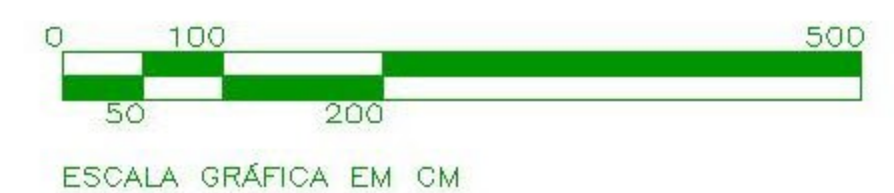

SALÃO PRINCIPAL

SALÃO INTERMEDIÁRIO

Altar

ENTRADA SECUNDARIA

PÁTIO INTERNO

W.C MASCULINO

W.C FEMININO

ENFERMARIA

ESPAÇO FAMILIA

BERÇARIO

ESCRITÓRIO

SOBE SALÃO SUPERIOR

SHOW ROOM

SECRETARIA

Lounge

Doces

Lounge

HALL

ENTRADA PRINCIPAL

PLANTA BAIXA - PÁTIO INTERNO

PÁTIO INTERNO - 252 lugares + 28 (pais e padrinhos)
HALL - Mesa de doces e lounges

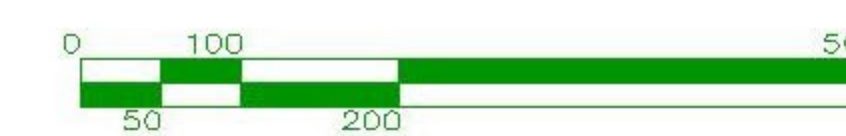

ESCALA GRÁFICA EM CM

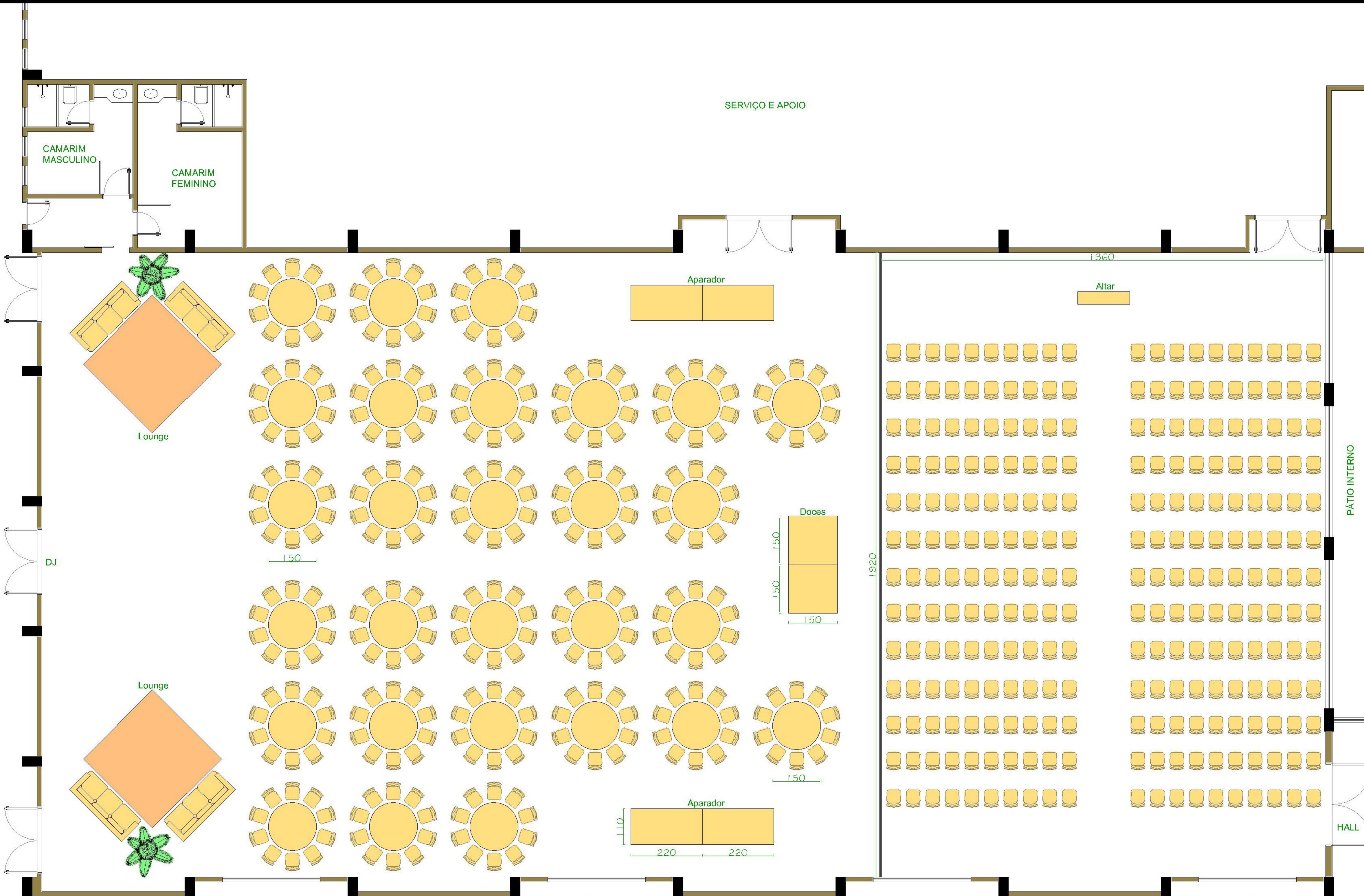

PLANTA BAIXA - SALÃO PRINCIPAL

SALÃO PRINCIPAL - 260 lugares na cerimônia e 280 lugares na recepção
 28 mesas com 10 lugares
 DJ, dois Lounges e mesa de doces

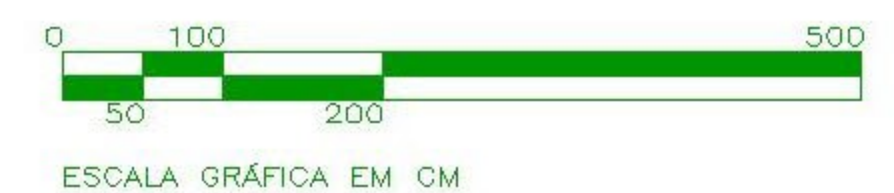

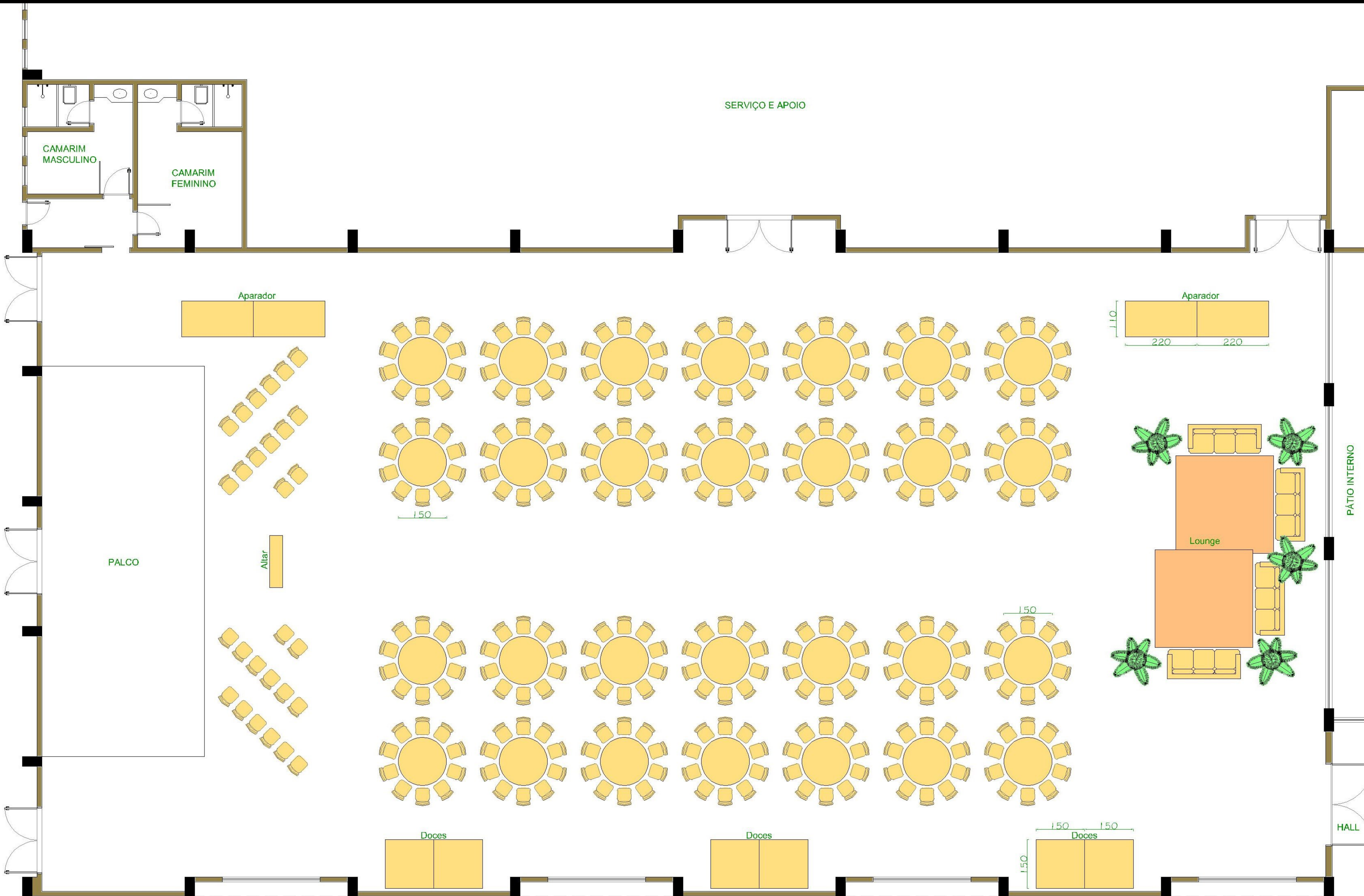

PLANTA BAIXA - SALÃO PRINCIPAL

SALÃO PRINCIPAL - 280 lugares
 28 mesas com 10 lugares
 Palco, altar, padrinhos, ilhas de doces e lounge

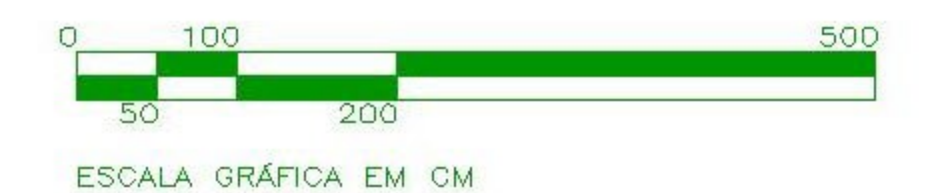

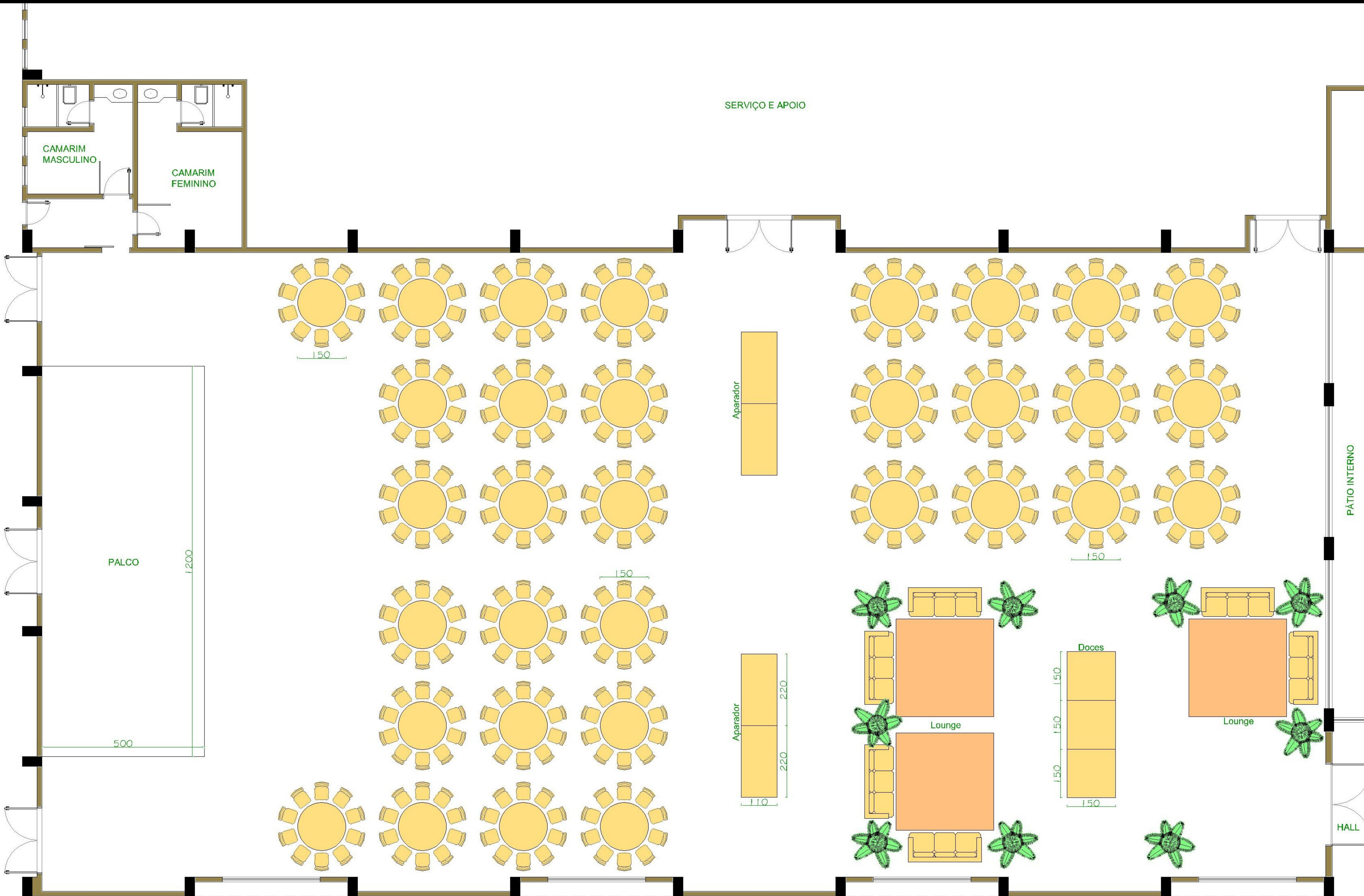

PLANTA BAIXA - SALÃO PRINCIPAL

SALÃO PRINCIPAL - 320 lugares
 32 mesas com 10 lugares
 Palco, sala de doces com lounge

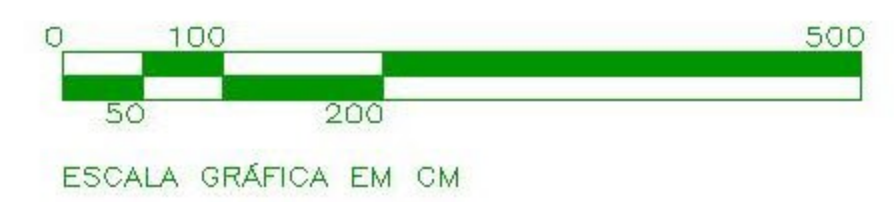

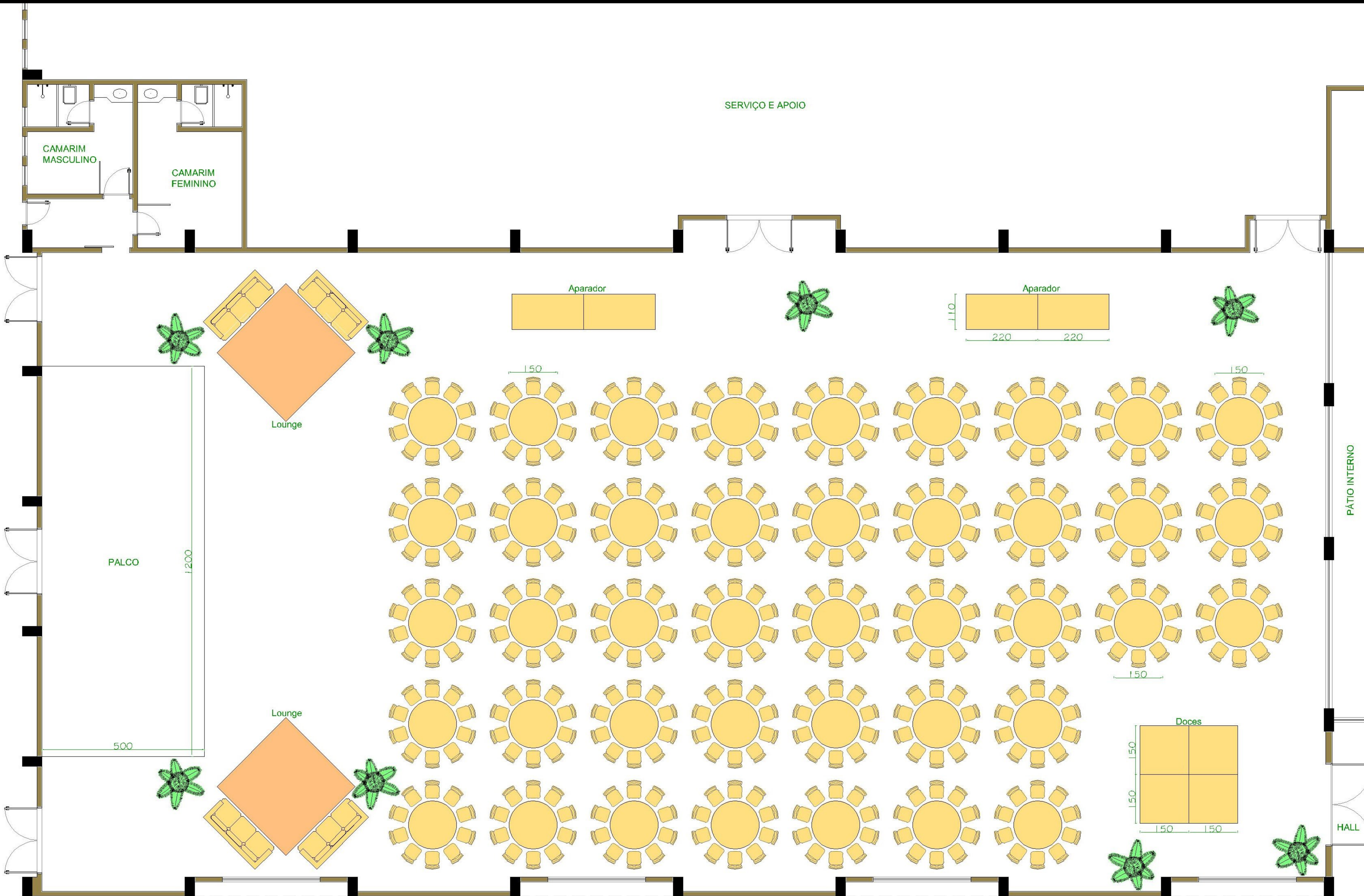

PLANTA BAIXA - SALÃO PRINCIPAL

SALÃO PRINCIPAL - 410 lugares
 41 mesas com 10 lugares
 Palco, mesa de doces e dois Lounges

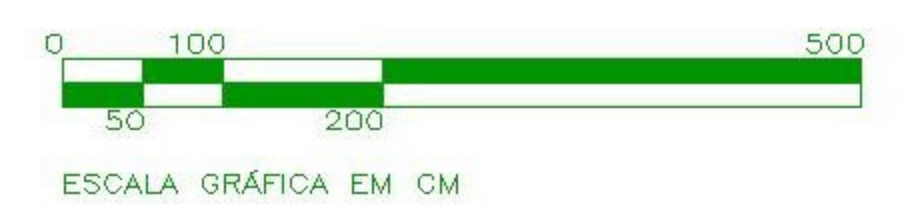

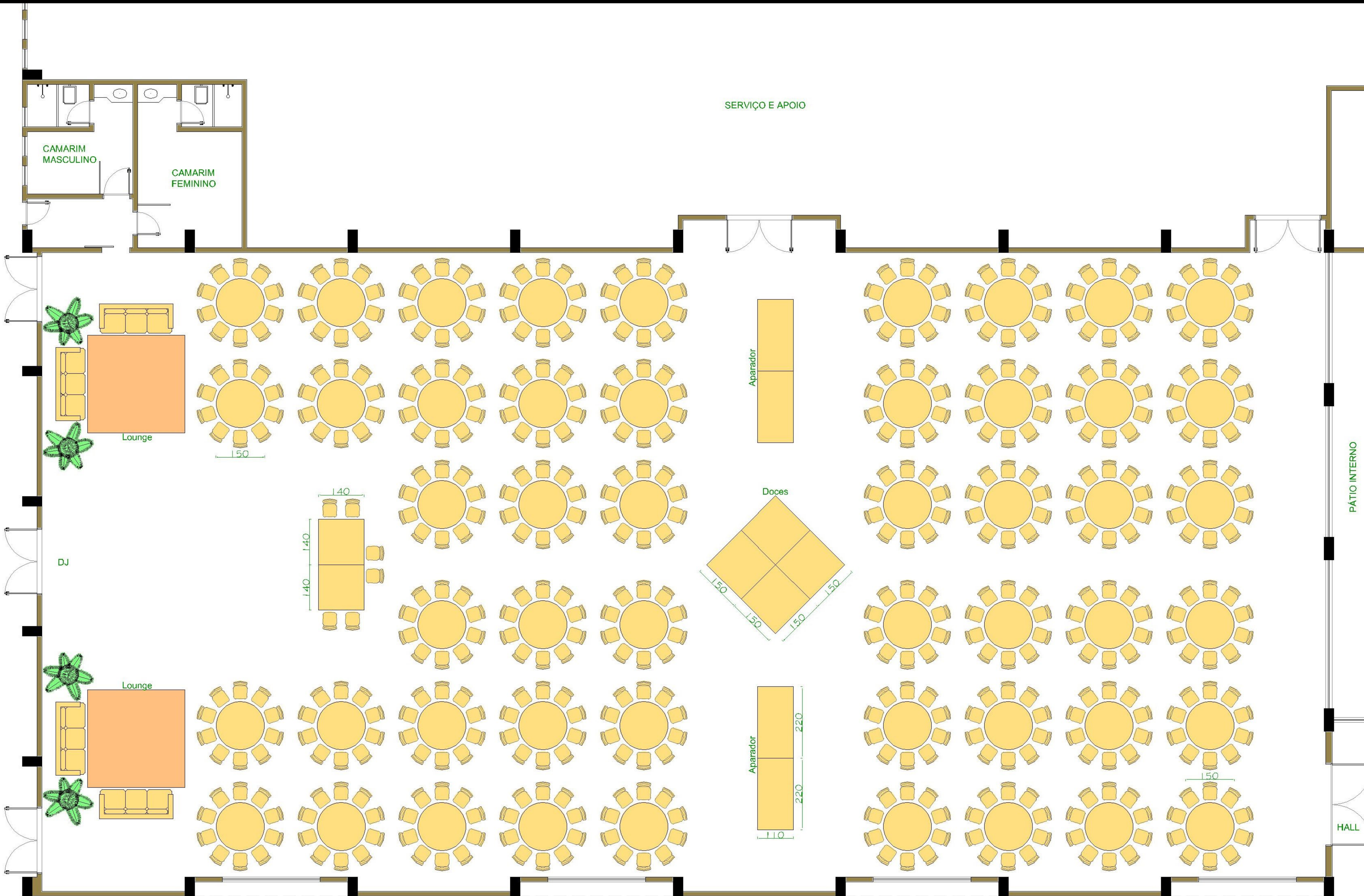

PLANTA BAIXA - SALÃO PRINCIPAL

SALÃO PRINCIPAL - 506 lugares
50 mesas com 10 lugares + banquete noivos
DJ, dois Lounges e mesa de doces

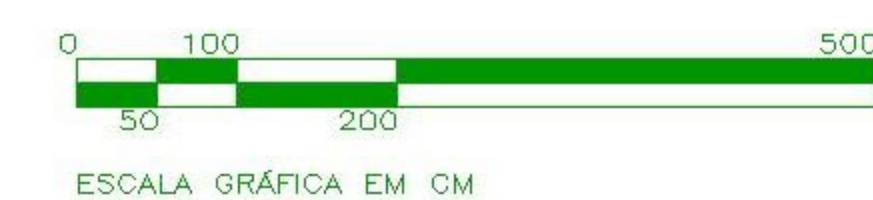

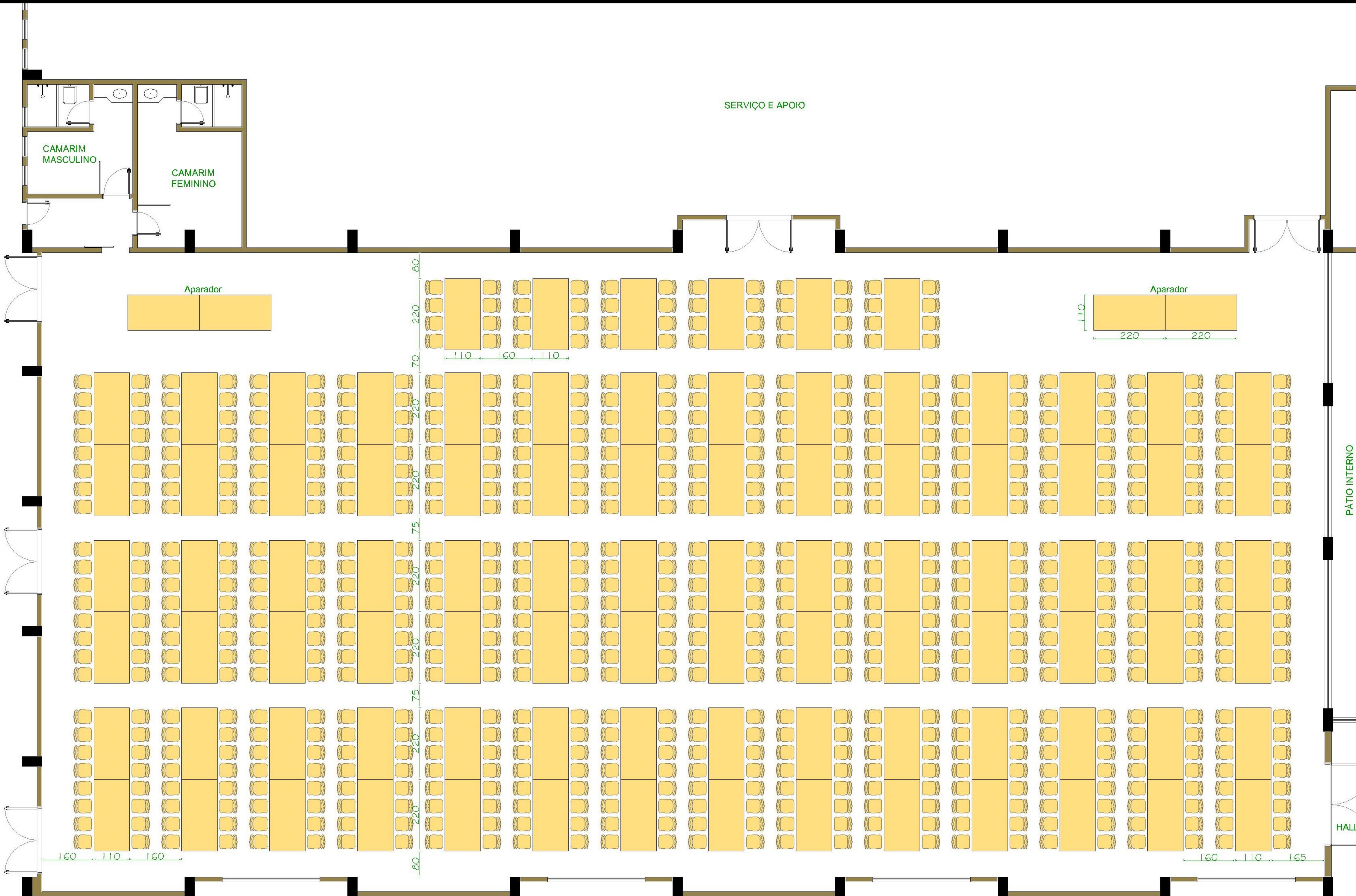

PLANTA BAIXA - SALÃO PRINCIPAL

SALÃO PRINCIPAL - 720 lugares
90 mesas com 08 lugares

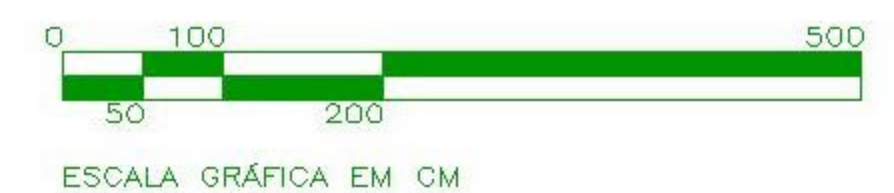

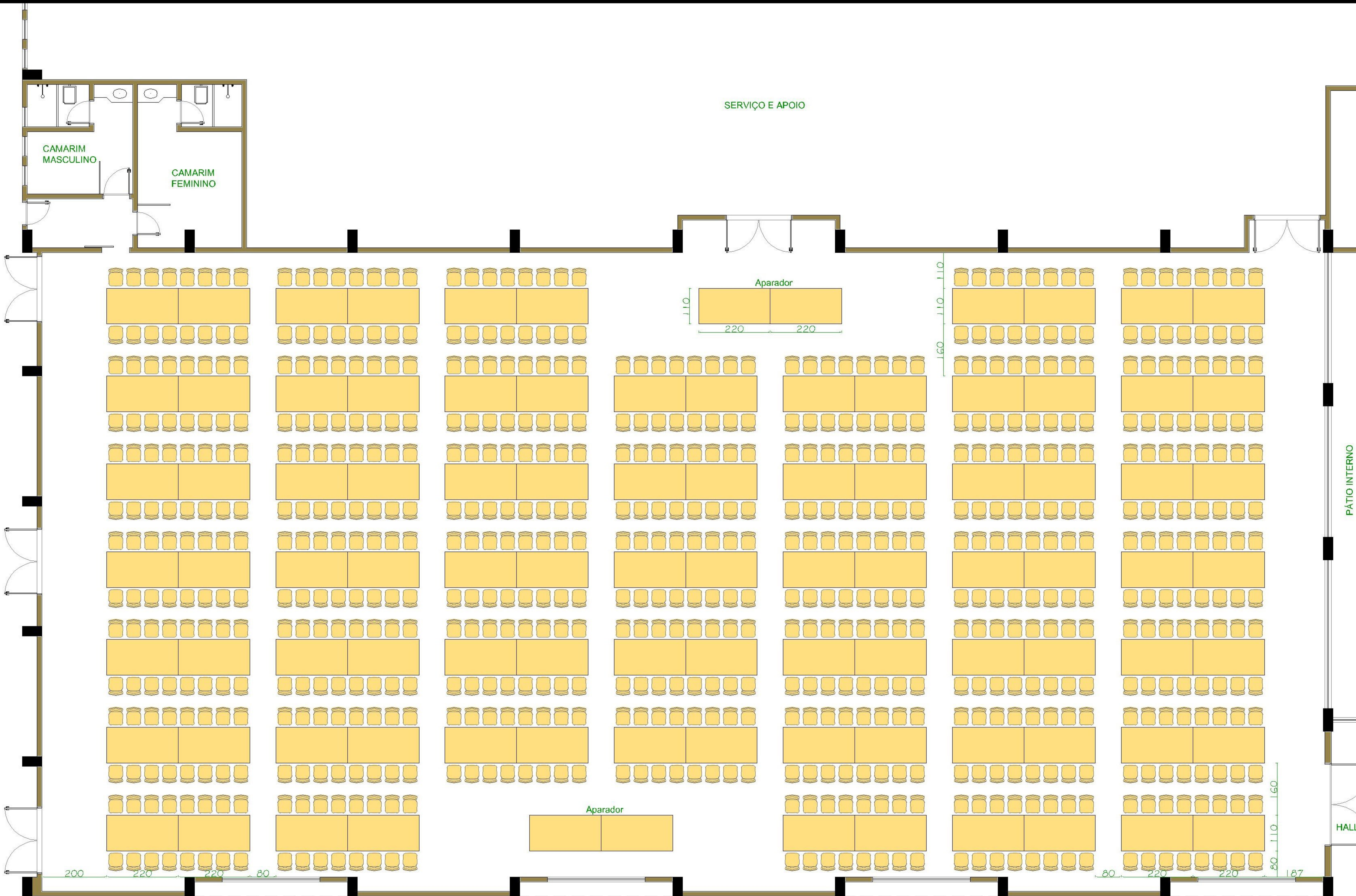

PLANTA BAIXA - SALÃO PRINCIPAL

SALÃO PRINCIPAL - 720 lugares
90 mesas com 08 lugares

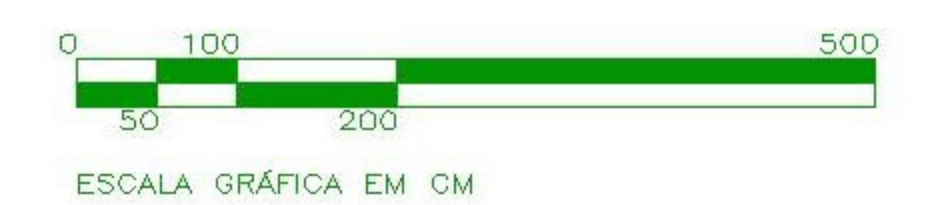

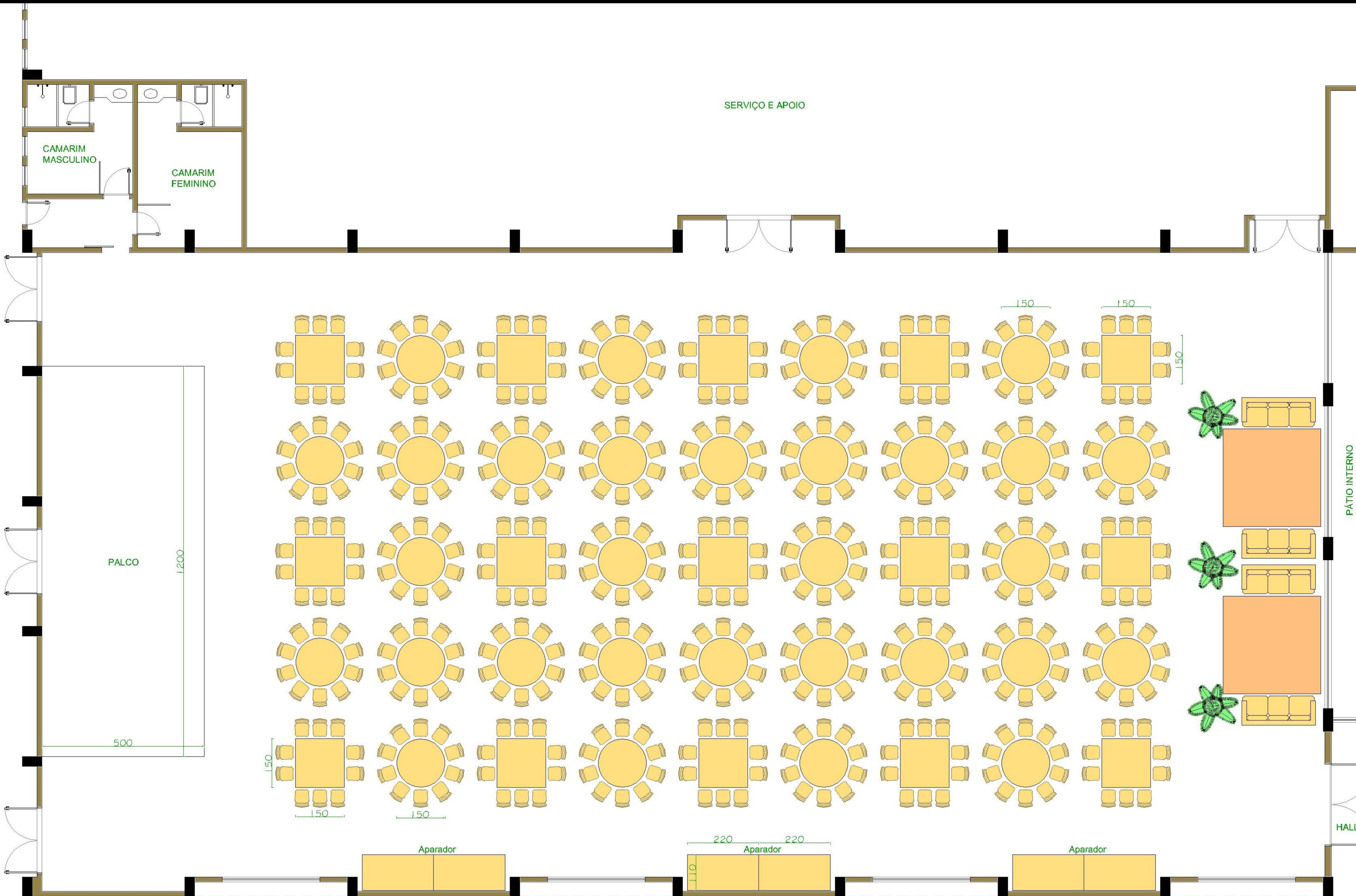

PLANTA BAIXA - SALÃO PRINCIPAL

SALÃO PRINCIPAL - 450 lugares
45 mesas com 10 lugares
Palco, aparadores de apoio e lounges

